

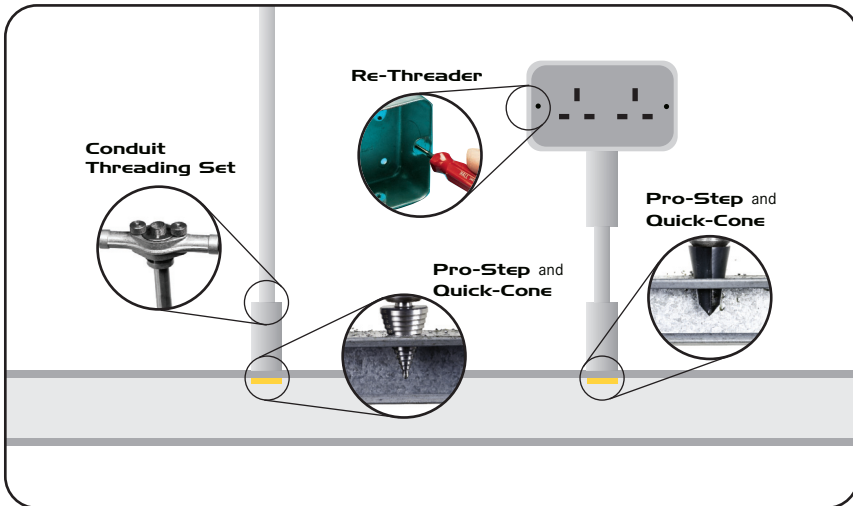

## The Solution to Conduit Installation

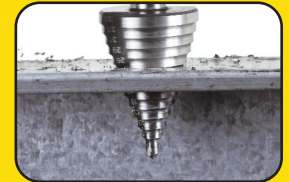

## Conduit Installation Range



### PRO-STEP

For the ultimate in consistently accurate holes in trunking & sheet steel.



### QUICK-CONE

The most versatile tool for quick and easy holes in trunking & sheet steel.

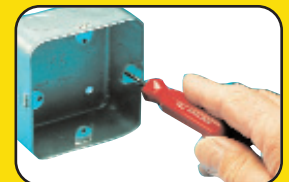

### RE-THREADER

Quickly and cleanly rethreads for easy installation of back boxes.



### CONDUIT THREADING SET

Rapidly produces accurate threads for secure and professional conduit installation.



### CUTTING COMPOUND

Maintains sharpness and tool life. Always use when drilling with Armeg **Pro-Step** & **Quick-Cone**.

## Conduit Installation Range Point of Sale

